





P	Code	Description	Q	Note	Validity	P	Code	Description	Q	Note	Validity

Revision:

Date: 12/04/2024

Oil type:

Oil quantity:

Validity: < XX/YY = From week/year

C= Tightening torque (Tolerance +0 ÷ -10%)

** = Not present for electric pump*



Series 194

XW

1450rpm

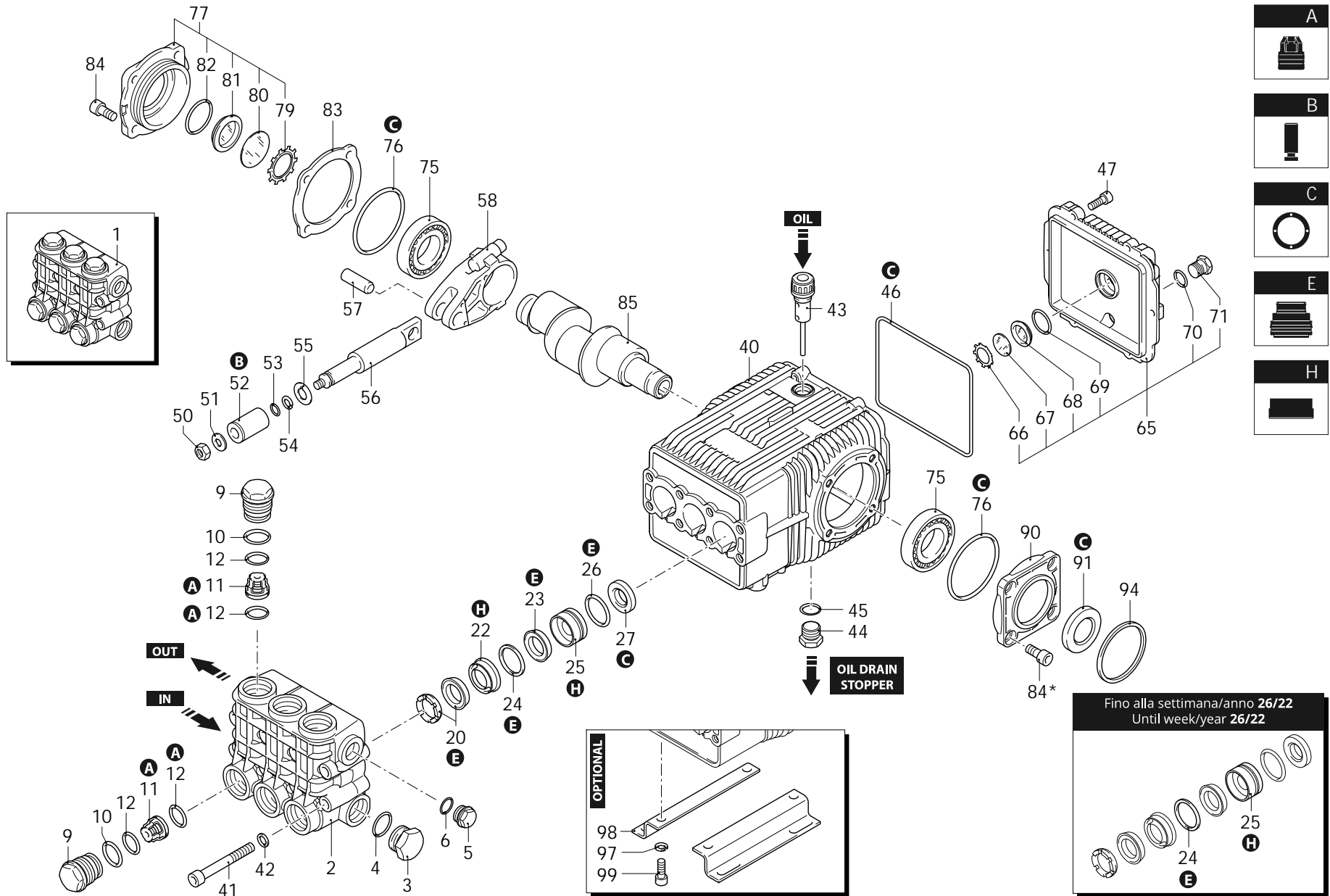

- A**
- B**
- C**
- E**
- H**

AR_s194-13_022



Series 194

XW

1450rpm

P	Code	Description	Q	Note	Validity	P	Code	Description	Q	Note	Validity
1	1949203	Head assembly	1	Ø 22		67	1780690	Plate	1		
2	1941210	Head	1			68	1260250	Level gauge	1		
3	1140300	Plug	1	3/4" G	C=35Nm	69	1140450	O-ring	1	Ø 20,24x2,62	Lubricate with grease Molykote PG54
4	550350	O-ring	1	Ø 23,81x2,62		70	740290	O-ring	1	Ø 14x1,78	Lubricate with grease Molykote PG54
5	1980740	Plug	1	3/8" G brass	C=20Nm	71	1980740	Plug	1	3/8" G brass	C=20Nm
6	740290	O-ring	1	Ø 14x1,78	Lubricate with grease Molykote PG54	75	1140410	Bearing	2		
9	1940140	Plug	6		Screw with Loxeal 55-14 / C=7Nm	76	1941380	O-ring	2	Ø 66,34x2,62	
10	1940150	Ring	6	anti-extrusion		77	1949011	Cover	1		
11	1949050	Complete valve	6			79	1941290	Ring	1		
12	1140450	O-ring	12	Ø 20,24x2,62	Lubricate with grease Molykote PG54	80	1941260	Plate	1		
20	1940270	Gasket	3	Ø 22	Lubricate with grease Molykote PG54	81	1941270	Level gauge	1		
22	1940200	Piston guide	3	front Ø 22		82	100410	O-ring	1	Ø 34,6x2,62	
23	1940480	Gasket	3	Ø 22	Lubricate with grease Molykote PG54	83	1941390	Shim 0.05mm	1		
24	1941220	O-ring	3	cut Ø 22	< 26/22	83	1941400	Shim 0.10mm	1		
24	2283660	O-ring	3	cut Ø 22		83	1941410	Shim 0.19mm	1		
25	1940460	Piston guide	3	rear Ø 22	< 26/22	83	1941420	Shim 0.25mm	1		
25	1944630	Piston guide	3	rear Ø 22		84	850370	Screw	4	TCEI M8x16	C=24,5Nm
26	820490	O-ring	3	Ø 34,65x1,78		84*	850370	Screw	4	TCEI M8x16	C=24,5Nm
27	1943730	Ring	3	seal		85	1942050	Shaft	1	1 marked	
40	1941330	Pump body	1			90	1941240	Support	1		
41	1940260	Screw	8	TCEI M10x80	C=50Nm	91	820681	Ring	1	seal	Screw with Loxeal 55-14 / C=10Nm
42	650530	Washer	8			94	1780430	Ring	1		
43	1140370	Oil plug	1	with oil dipstick		97	200231	Washer	4		
44	1980740	Plug	1	3/8" G brass	C=20Nm	98	1940370	Foot	2		
45	740290	O-ring	1	Ø 14x1,78	Lubricate with grease Molykote PG54	99	1940380	Screw	4	TCEI 10x18	C=50Nm
46	1940410	O-ring	1	Ø 132x3		A	2780	Valve kit	1		
47	1200430	Screw	6	TCEI M6x16	Screw with Loxeal 55-14 / C=10Nm	B	1891	Piston kit	1	Ø 22	
50	1940570	Nut	3	M8	Screw with Loxeal 55-14 / C=20Nm	C	2873	Oil seal kit	1		
51	1940580	Washer	3			E	2783	Water seal kit	1	Ø 22	
52	1420120	Piston	3	Ø 22		E	2779	Water seal kit	1	Ø 22 Viton	
53	880840	O-ring	3	Ø 9,25x1,78	Lubricate with grease Molykote G807	H	2785	Piston guide kit	1	Ø 22	< 26/22
54	1940120	Ring	3	anti-extrusion		H	47164	Piston guide kit	1	Ø 22	
55	960460	Plate	3								
56	1940070	Piston	3	guide							
57	1940060	Pin	3								
58	1940051	Connecting-rod	3	aluminium	Lubricate with grease Molykote BR2 PLUS / C=20Nm						
65	1949010	Cover	1	complete							
66	1260430	Ring	1								

Revision: 1

Oil type: SAE 15W40

Validity: < XX/YY = From week/year

Date: 12/04/2024

Oil quantity: 0,870 Kg

C= Tightening torque (Tolerance +0 ÷ -10%)

* = Not present for electric pump



Series 194

XW

1450rpm

P	Code	Description		Q	Note	Validity
1	1383550	Flange	F38	1		
2	620610	Screw	TCEI M8x30	4	Screw with Loxeal 55-14 / C=24,5Nm	

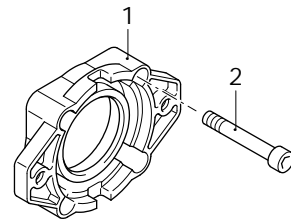

F38

AR-1_flangia-21_v01

Revision: 1

Oil type: SAE 15W40

Validity: < XX/YY = From week/year

Date: 12/04/2024

Oil quantity: 0,870 Kg

C=Tightening torque (Tolerance +0 ÷ -10%)

22318 - XW 30.15 + F38