

Model Number: 8000-955-280

Pump Design:

Pump Type: Positive Displacement 3 Chambers Diaphragm Pump

Ports: 3/8"-18 NPT Female

Dry-Prime: Yes

Run Dry: Yes

Check Valve: No

Drive Type: 2.0° Cam, Solid Diaphragm

Max Inlet Pressure: 2.07BAR (30 PSI)

Electrical:

Motor: Permanent Magnet 24VDC

Duty cycle: Intermittent

Control: Internal Bypass Set at @ 5.5BAR (80PSI)

Performance:

Open Flow: 3.8L/min (1 GPM) @ 24VDC

Test criteria: Min Flow: 2.3L/min (0.6GPM) @ 3.4BAR (50PSI) and 24VDC

Material of Construction:

Plastics/Housing: Nylon

Valves: Santoprene™

Diaphragm(s): EPDM

Shipping Information:

Approx. Net Weight: 2.4 kg ea.

Box Quantity: 6

Approx. Carton Size: [594 mm x 441 mm x 127 mm]

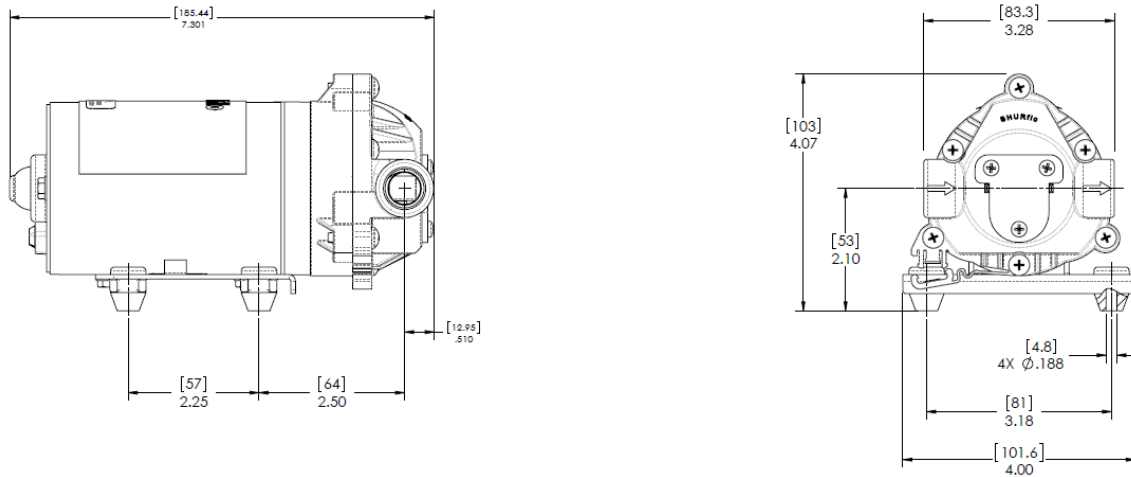
Dimensions:

Nominal dimensions shown in inches [mm]

*Specifications subject to change without notice.
 All data based on testing with water at ambient temperature*

PENTAIR WATER BELGIUM bvba

Industriepark Wolfstee, Toekomstlaan 30, B-2200 Herentals, Belgium

TEL: +32-14-259-911 FAX: +32-14-259-975 email: shurflo.service@PENTAIR.COM