

COIL - TUBE Ø 13,25

22 W

- Wire insulation class.....H (>185°C)
- ED.....100%
- Coil power at 20° C.....22 W
- Ambient temperature.....-20 +40° C
- Weight.....0,19 Kg

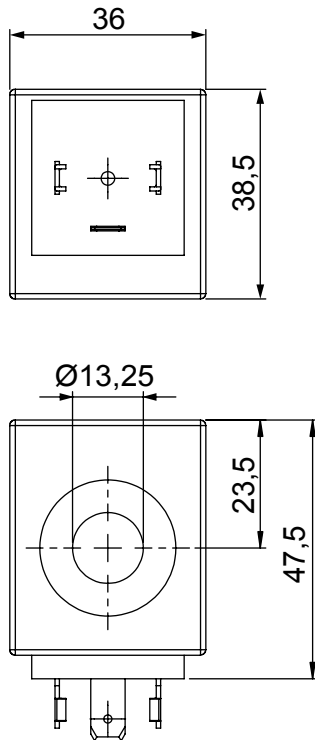

ELECTRIC CIRCUITS

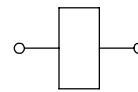

STANDARD

266

Note:
- Coil interchangeable with CT-9400 model.

| CONNECTOR | PROTECTION CLASS | COIL THERMAL INSULATION CLASS | VOLTAGE [V] | RESISTANCE [Ω] | CIRCUIT | ORDERING CODE |
|----------------|------------------|-------------------------------|-------------|----------------|----------|------------------|
| DIN 43650 | IP65* | F | 12 V dc | 6,5 | STANDARD | 092001130 |
| DIN 43650 | IP65* | F | 14 V dc | 8,9 | STANDARD | 092001132 |
| DIN 43650 | IP65* | F | 24 V dc | 26,5 | STANDARD | 092002130 |
| DIN 43650 | IP65* | F | 26 V dc | 30,6 | STANDARD | 092002132 |
| AMP-JUNIOR | IP65* | F | 12 V dc | 6,5 | STANDARD | 092201130 |
| AMP-JUNIOR | IP65* | F | 24 V dc | 26,5 | STANDARD | 092202130 |
| AMP-JUNIOR | IP65* | F | 26 V dc | 30,6 | STANDARD | 092202131 |
| CABLE L=300mm | IP65* | F | 14 V dc | 8,9 | STANDARD | 092601130 |
| CABLE L=300mm | IP65* | F | 26 V dc | 30,6 | STANDARD | 092602130 |
| AMP-SUPER SEAL | IP67* | F | 24 V dc | 26,5 | STANDARD | 092702130 |

* Protection index with standard connector