

Series Industrial in STAINLESS STEEL

Air - Water 20 bar

swivel
seals
hose

Brass
Viton
Polyurethane
Black synthetic rubber



S. 560

S. 540

S. 530

S. 430

S. 350

S. 300 S. 270



THE HOSE REELS ARE EQUIPPED WITH A UNIVERSAL HOSE STOP; THOSE WITH HOSE ARE PROVIDED WITH A 0,6 m INLET CONNECTION HOSE.

- The template supplied, facilitates drilling of the holes and therefore hose reel fixing.



- The quick coupling support (see page 82) that facilitates installation in battery is available on request.

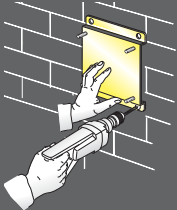

- The quick coupling adjustable support (see page 82) that enables 40° rotation to the right or left of the hose reel is available on request.

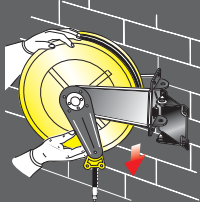

- The adjustable arms can be easily repositioned according to needs (see page 77).

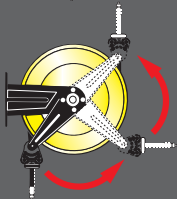

OVERALL DIMENSIONS

Series	A	B	C	D	E	F	G	H
270	186	140	196	226	110	310	300	320
300	186	140	196	226	110	355	350	365
350	186	140	196	226	110	400	390	410
430	186	140	196	226	115	450	420	460
530	203	153	220	258	115	550	510	560
540	300	218	228	268	190	550	510	573
560	488	399	238	272	368	522	510	578

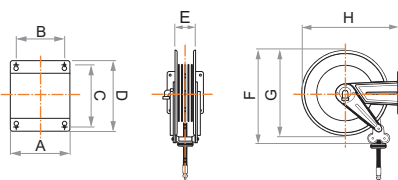

	Article	Capacity l/min Air-Water	Delivery hose	ø Hose	Inlet connection	Outlet connection
Series 270	272/10	800 - 35	without hose	/	F 3/8"G	F 3/8"G
	272/11	710 - 27	10m (952/10)	3/8"	F 3/8"G	M 3/8"G
	272/12	690 - 30	13m (921/13)	PU 10x14,5	F 3/8"G	M 3/8"G
	272/13	320 - 18	15m (911/15)	PU 8x12	F 3/8"G	M 1/4"G
		N° 1 packing m³ 0,037		from kg 7 to 12		

Series 300	302/10	800 - 35	without hose	/	F 3/8"G	F 3/8"G
	302/11	690 - 25	12m (952/12)	3/8"	F 3/8"G	M 3/8"G
	302/12	670 - 28	15m (921/15)	PU 10x14,5	F 3/8"G	M 3/8"G
	302/13	300 - 15	18m (911/18)	PU 8x12	F 3/8"G	M 1/4"G
		N° 1 packing m³ 0,045		from kg 8 to 13		

Series 350	352/10	800 - 35	without hose	/	F 3/8"G	F 3/8"G
	352/11	660 - 23	18m (952/18)	3/8"	F 3/8"G	M 3/8"G
	352/12	650 - 25	20m (921/20)	PU 10x14,5	F 3/8"G	M 3/8"G
	352/13	280 - 13	20m (911/20)	PU 8x12	F 3/8"G	M 1/4"G
	352/14	690 - 25	12m (952/12)	3/8"	F 3/8"G	M 3/8"G
		N° 1 packing m³ 0,068		from kg 10 to 17		

Series 430	432/10	800 - 50	without hose	/	F 1/2"G	F 1/2"G
	432/11	760 - 47	15m (962/15)	1/2"	F 1/2"G	M 1/2"G
	432/12	690 - 30	12m (952/13)	3/8"	F 1/2"G	M 3/8"G
	432/13	660 - 25	18m (952/19)	3/8"	F 1/2"G	M 3/8"G
	432/14	780 - 48	10m (962/10)	1/2"	F 1/2"G	M 1/2"G
		N° 1 packing m³ 0,086		from kg 14 to 24		

Series 530	532/10	800 - 50	without hose	/	F 1/2"G	F 1/2"G
	532/11	750 - 45	20m (962/20)	1/2"	F 1/2"G	M 1/2"G
	532/12	740 - 43	25m (962/25)	1/2"	F 1/2"G	M 1/2"G
		N° 1 packing m³ 0,120		from kg 19 to 42		

Series 540	542/10	3000 - 120	without hose	/	F 1"G	F 1"G
	542/11	2800 - 100	15m (972/15)	3/4"	F 1"G	M 3/4"G
	542/12	2750 - 95	20m (972/20)	3/4"	F 1"G	M 3/4"G
	542/13	3000 - 110	15m (982/15)	1"	F 1"G	M 1"G
	542/15	800 - 50	without hose	/	F 1/2"G	F 1/2"G
	542/16	720 - 40	30m (962/30)	1/2"	F 1/2"G	M 1/2"G
		N° 1 packing m³ 0,175		from kg 24 to 50		

Series 560	562/10	3000 - 120	without hose	/	F 1"G	F 1"G
	562/11	2700 - 90	30m (972/30)	3/4"	F 1"G	M 3/4"G
	562/12	2650 - 87	35m (972/35)	3/4"	F 1"G	M 3/4"G
	562/13	2600 - 85	40m (972/40)	3/4"	F 1"G	M 3/4"G
	562/14	2950 - 105	20m (982/20)	1"	F 1"G	M 1"G
	562/15	2900 - 100	30m (982/30)	1"	F 1"G	M 1"G
	562/16	800 - 50	without hose	/	F 1/2"G	F 1/2"G
	562/17	700 - 37	40m (962/40)	1/2"	F 1/2"G	M 1/2"G
	562/18	680 - 32	50m (962/50)	1/2"	F 1/2"G	M 1/2"G
	562/19	660 - 30	60m (962/60)	1/2"	F 1/2"G	M 1/2"G
		N° 1 packing m³ 0,310		from kg 30 to 80		