

Technical Data and Ordering Information



CartReg® - Miniature - In-Line Pre Set Regulator

Installation: The regulator ensures that a constant pressure is always maintained, despite the normal pressure fluctuations in a system. The regulator is intended for use with compressed air or neutral gases. The CartReg® must be mounted directly on the pneumatic blow gun or tool in order to ensure correct pressure, so that possible pressure drops in hoses, tubes etc. do not influence the pressure on the tool it self.

Thread Connection	Outlet Pressure	Tolerances* (at 10 ltrs. Min)	Flow Ltrs./min - scfm (Pe = 12bar/174 psig Δp:0.5 bar / 7 psig)	Dimensions (mm)		Weight Gram	Maximum Inlet Pressure	Temperature Range	Material	Order Code
				A	Across Flat					
1/4" BSP CartReg® male-male										
1/4"	2 bar	+/- 0,6 bar (Pe 6 bar)	350 / 12.5	24 mm	14 mm	16	12 bar 174 psig	- 20 °C to + 60°C (-4°F to 140°F)	Housing: Brass other parts: Steel, Stainless Steel, NBR,	233G0220
1/4"	3 bar	+/- 0,7 bar (Pe 6 bar)								233G0230
1/4"	4 bar	+/- 0,8 bar (Pe 6 bar)								233G0240
1/4"	6 bar	+/- 1 bar (Pe 10 bar)								233G0260
1/4"	8 bar	+/- 1.2 bar (Pe 10 bar)								233G0280
1/4" NPT CartReg® male-male										
1/4"	2 bar / 30 psig	+/- 8,7 psig (Pe 87 psig)	350 / 12.5	28 mm	14 mm	18	12 bar 174 psig	- 20 °C to + 60°C (-4°F to 140°F)	Housing: Brass other parts: Steel, Stainless Steel, NBR,	233S1230
1/4"	3 bar / 45 psig	+/- 10.1 psig (Pe 87 psig)								233S1245
1/4"	4 bar / 60 psig	+/- 11,6 psig (Pe 87 psig)								233S1260
1/4"	6 bar / 90 psig	+/- 14,5 psig (Pe 145 psig)								233S1290
1/4"	8 bar / 120 psig	+/- 17,5 psig (Pe 145 psig)								233S12120
On request:	Other pre-set pressures									

Tolerances* Test medium: Air, 10NI/Min / 0.35scfm

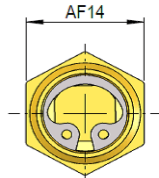
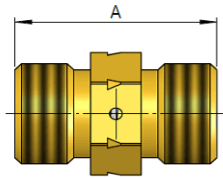

Accessoires:

Thread adapter G 1/4" female, mountable on both sides

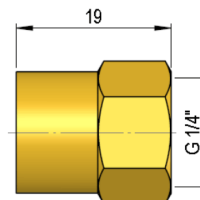
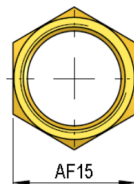
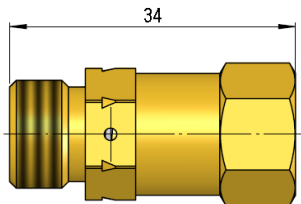
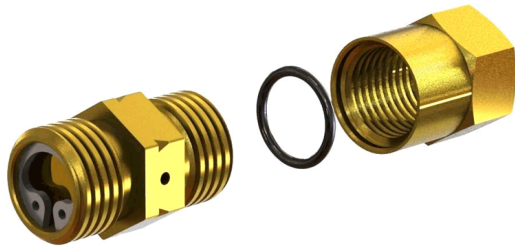

Thread	Code	Material	Weight
BSP 1/4	263 F 0221 IG 1/4"	Brass	9g
	CartReg® Adapter-Set	O-Ring Nitril	

The CartReg® is not included in the adapter set.