

**HAND PUMP MODULAR MANIFOLD**

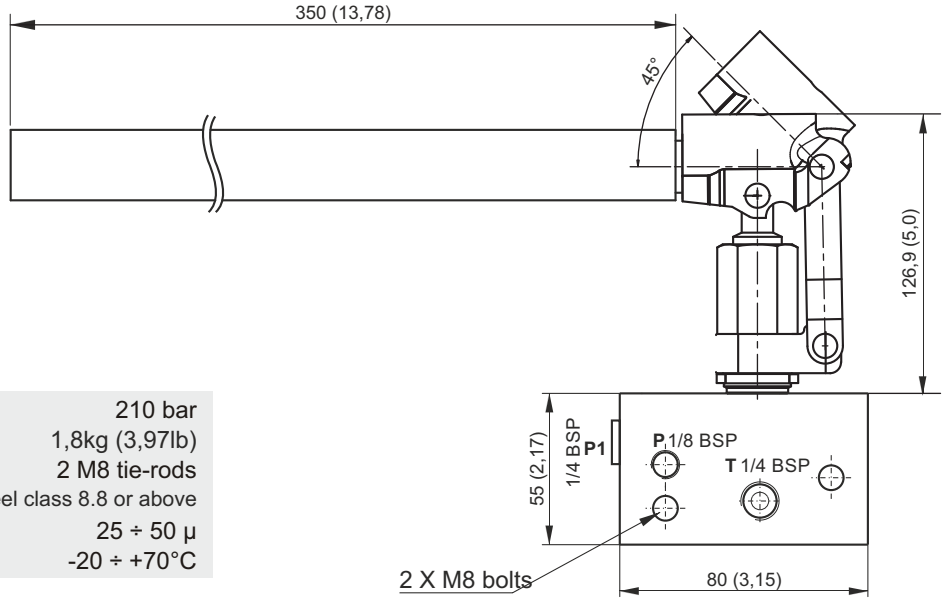

Dimensions in mm (inches)

**Main features**

<b>Max pressure</b>	210 bar
<b>Weight</b>	1,8kg (3,97lb)
<b>Fixing bolts</b>	2 M8 tie-rods steel class 8.8 or above
<b>Filtration grade</b>	25 + 50 μ
<b>Fluid temperature</b>	-20 ÷ +70°C

**Effort (daN)**

operating on the top of the lever

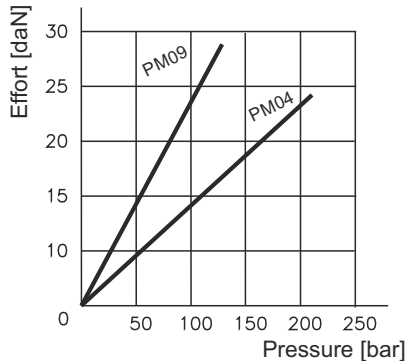

Note: Values are measured only on the valve (no cavity) with oil viscosity of 46 cSt at 50 °C. The drop of the pressure can change by the fluid viscosity and fluid temperature.

Block thickness: 39mm (1,54)

**Spare part codes - cartridges only**

Description	Spare part code
4cc hand pump 7/8-14UNF cartridge + lever	<b>CARTPM04L</b>
8,8cc hand pump 7/8-14UNF cartridge + lever	<b>CARTPM09L</b>

**Mounting example**

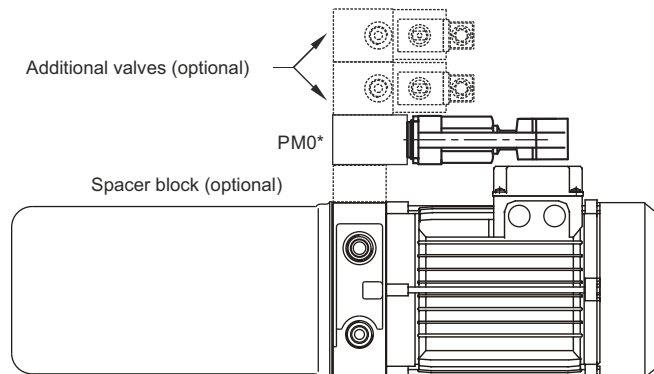

Spare part code	Displacement cc/stroke
<b>PM04</b>	<b>4</b>
<b>PM09</b>	<b>8,8</b>

Note: Recommended tightening torque for M8 bolts: 16 Nm. Attention! Do not use tie-rods less than 8.8.

Commissioning: the pump must be bled by opening the plug of the unused pressure port (P or P1), pumping a few times until all air bubbles and then clean oil come out, then tightening the plug again.